

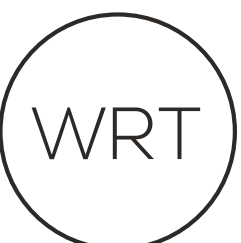

SCHEMATIC DESIGN

FRESNO MARIPOSA PLAZA

08 FEBRUARY, 2021





GROUND-LEVEL PLAN



SHADE STRUCTURE PLAN

HOLIDAY EVENTS DIAGRAM



SHADOW STUDY

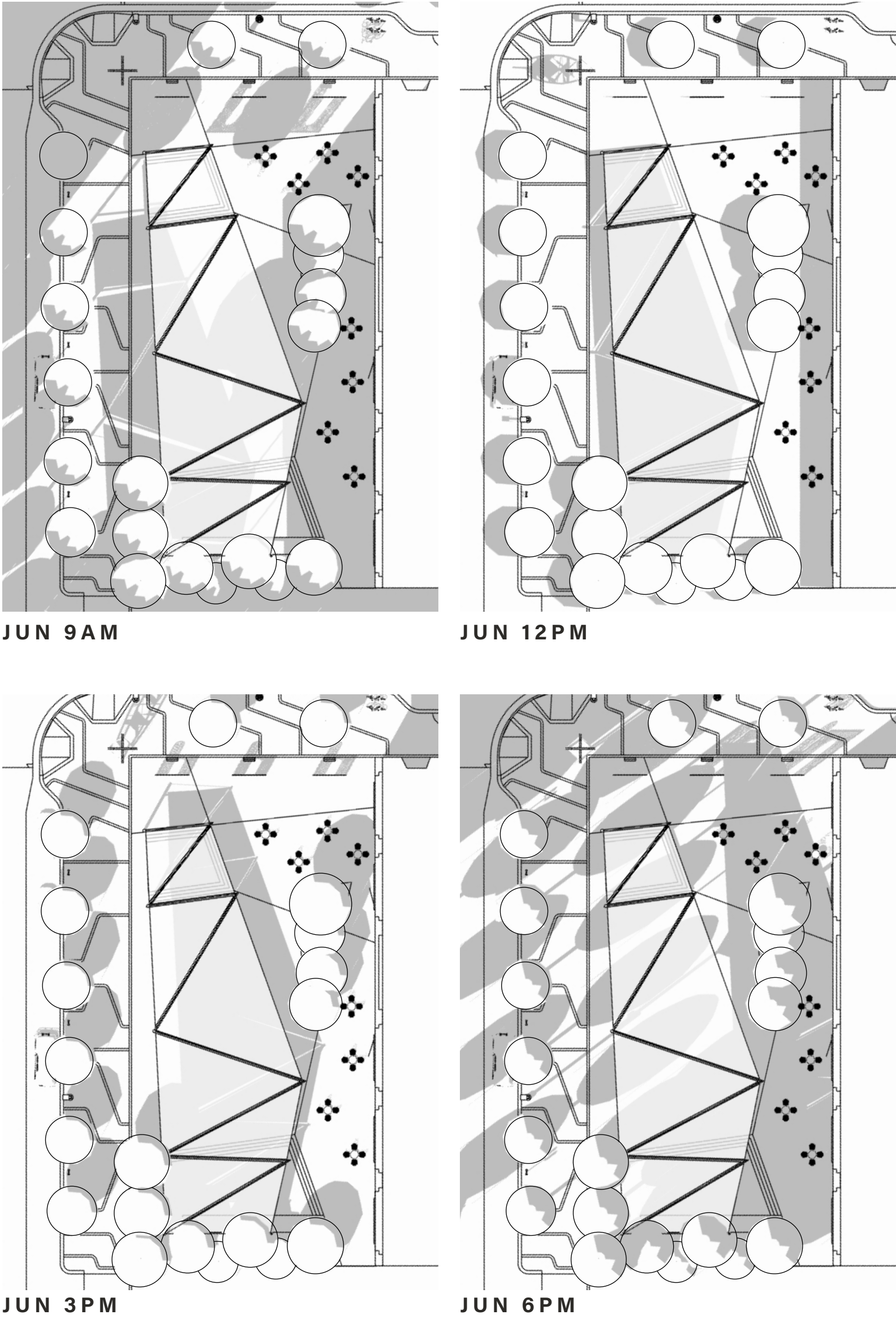

SECTION

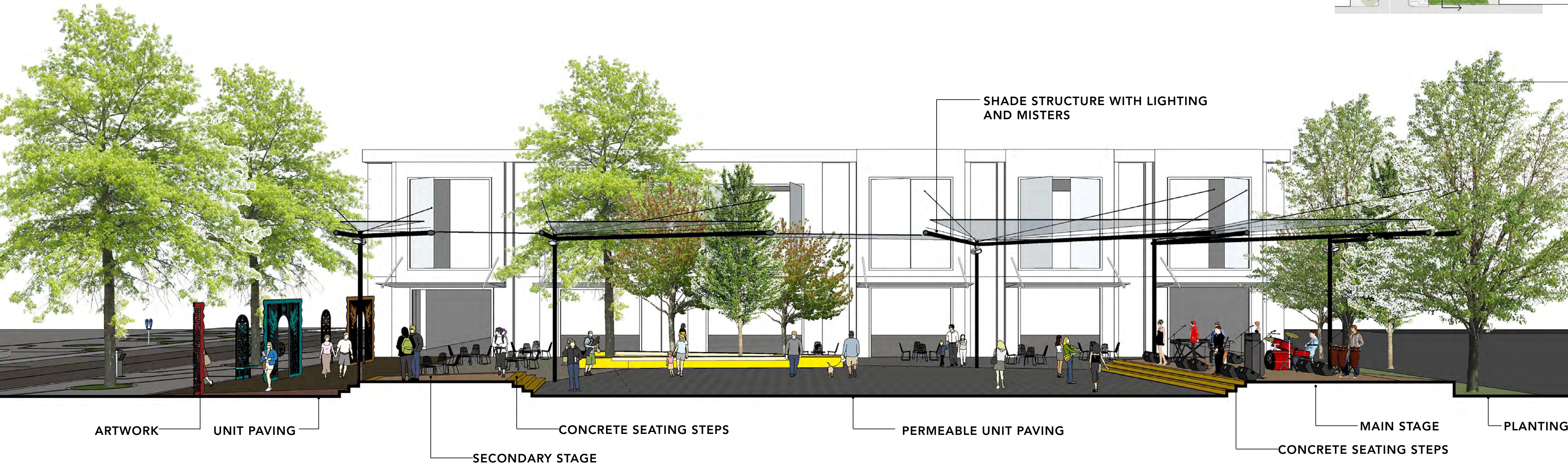

PRECEDENT IMAGES

STAGE

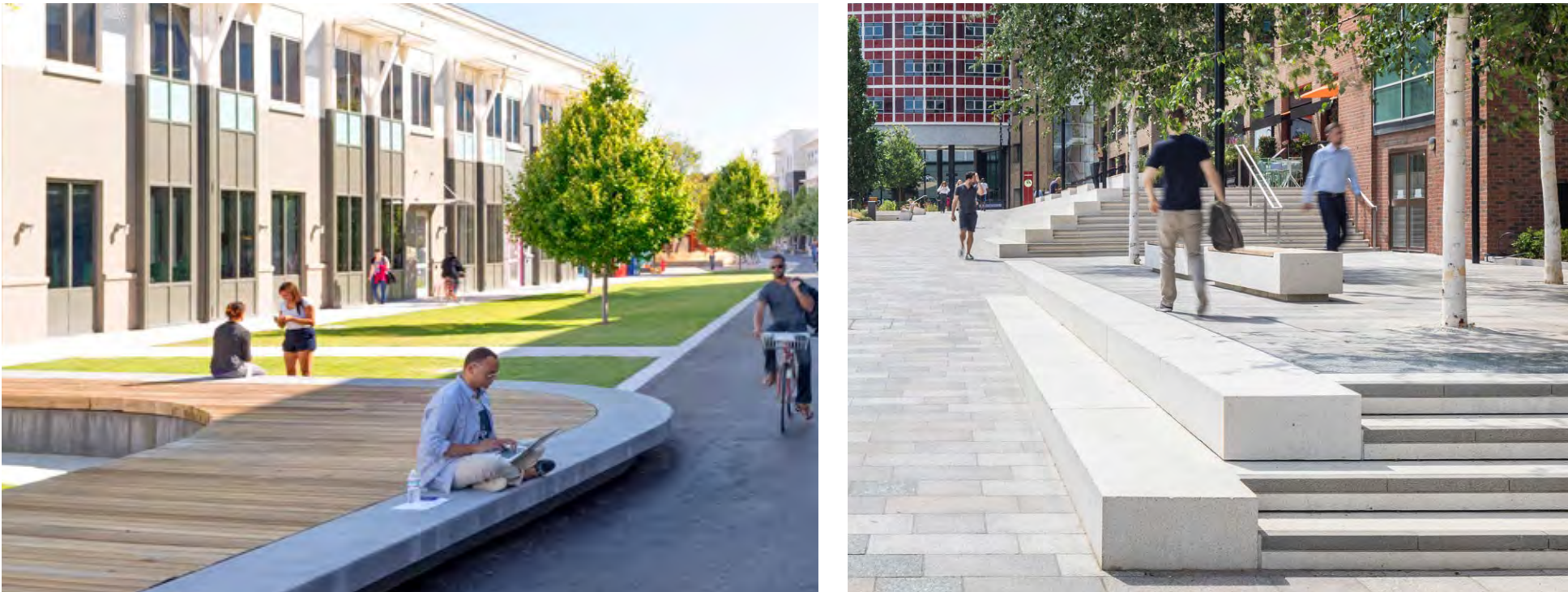

The proposed stages consist of wood decking infill surrounded by concrete seating steps and access steps. The wood species would not require preservatives or treatment, such as redwood or ipe.

SHADE STRUCTURE



The proposed shade structure consists of tensile fabric shade panels with steel frame. (See renderings.) The shade structure would also support site and stage lighting and misters.

PLANTING



Planting will be a variety of drought-tolerant, low-water-use plants and trees. Planting area will be surrounded by a concrete seat-wall with wood seating elements.

SEAT WALLS



Cast-in-place concrete or precast concrete (to be determined) with wooden bench tops. Seating steps and seat-walls will be designed with anti-skateboarding elements.

Note: These precedent images represent the schematic design intent and are not representative of final materials or furnishings selections, which will be made during the Design Development phase.

PRECEDENT IMAGES

MOVEABLE FURNITURE



Movable tables and chairs will provide flexible seating, allowing users sit in the shady locations at different times of day and seasons, and allowing for flexibility during events.



PAVING

PERMEABLE PAVING



ENHANCED CAST-IN-PLACE CONCRETE

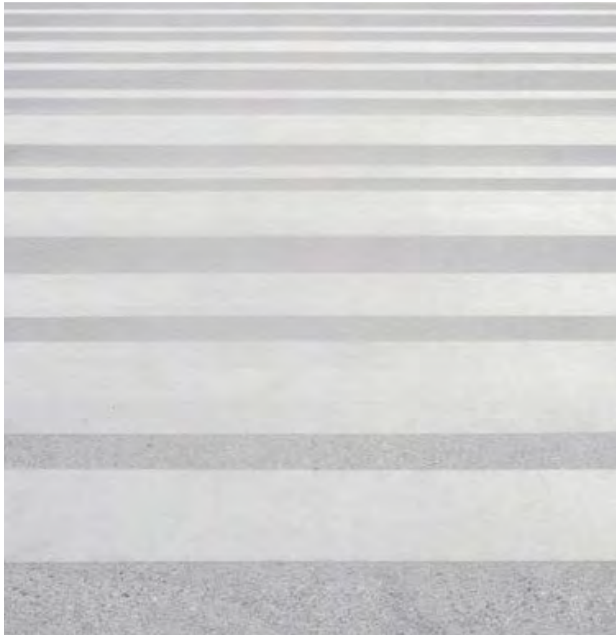

IMPERMEABLE UNIT PAVING



A variety of paving types is proposed (see illustrative plan). Permeable paving would meet the TCC grant requirement for stormwater treatment.

LIGHTING

LIGHT POLE



STRIP LIGHTING



FLOOD LIGHT



The design proposes one light multi-fixture pole in the northeastern corner. Floodlights would be attached to the shade structure poles, and would be separately controlled for everyday lighting and stage lighting during events. Strip lighting would accent seating elements and the shade structure beams (see renderings).

MIST



Misters are proposed to be installed on the shade structure poles and/or beams.

Note: These precedent images represent the schematic design intent and are not representative of final materials or furnishings selections, which will be made during the Design Development phase.











